

PRINCIPAL PARTICULARS

LENGTH O.A.	abt.179.90 m	COMPLEMENT	25P
LENGTH B.P.	171.50 m	SPEED	
BREADTH MLD.	28.40 m	SERVICE(d=10.00m, CSR(90%MCR) with 15% S.M.)	abt. 13.7 knots
DEPTH MLD.	15.00 m	TRIAL MAX.	abt.15.2 knots
DESIGNED DRAFT	10.00 m		
SCANTLING DRAFT	10.80 m		
DEADWEIGHT (DESIGNED DRAFT)	abt. 31,500 M.T.		
DEADWEIGHT (SCANTLING DRAFT)	abt. 35,000 M.T.		
GROSS TONNAGE (I.C.T.M.)	abt. 22,289		

MAIN ENGINE	
MAN B&W 6S42MC (MARK7)	1 SET
MCR	6480kWx136.0rpm
CSR(90%MCR)	5832kWx131.3rpm

CLASS NOTATION	
BV: 1	✳ HULL Bulk Carrier, CSR, BC-A,
	CPS(WBT), (Hold Nos.2,4 May be empty),ESP,
	VeriSTAR-HULL,IN WATER SURVEY,GRAB[20]
	✳ MACH AUT-UMS,MON-SHAFT

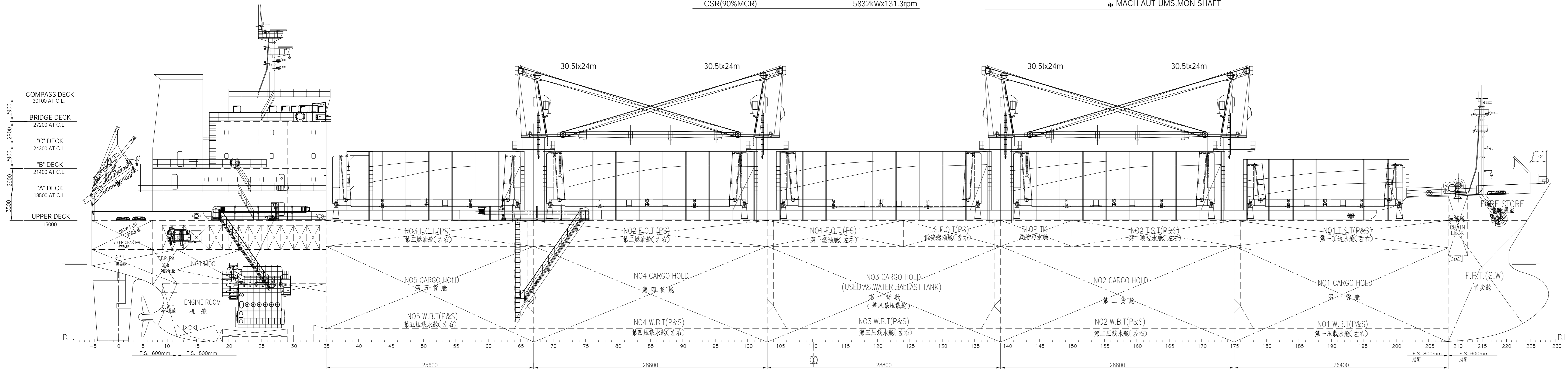

PROFILE  
侧视图

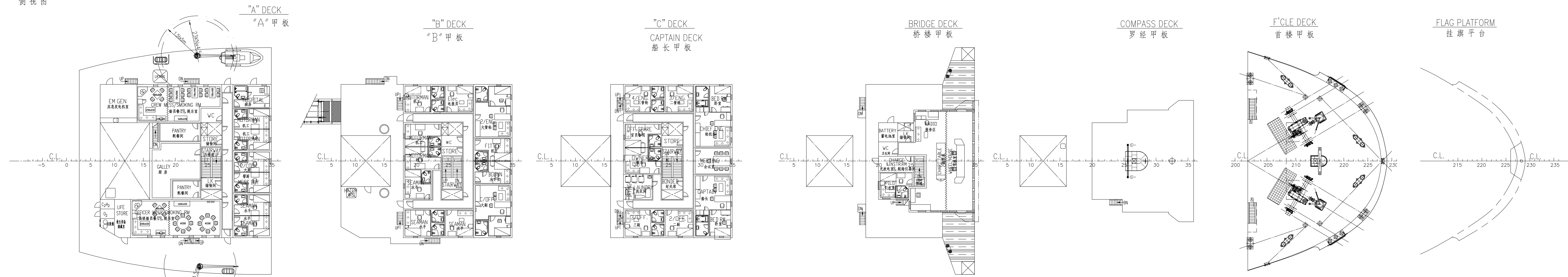
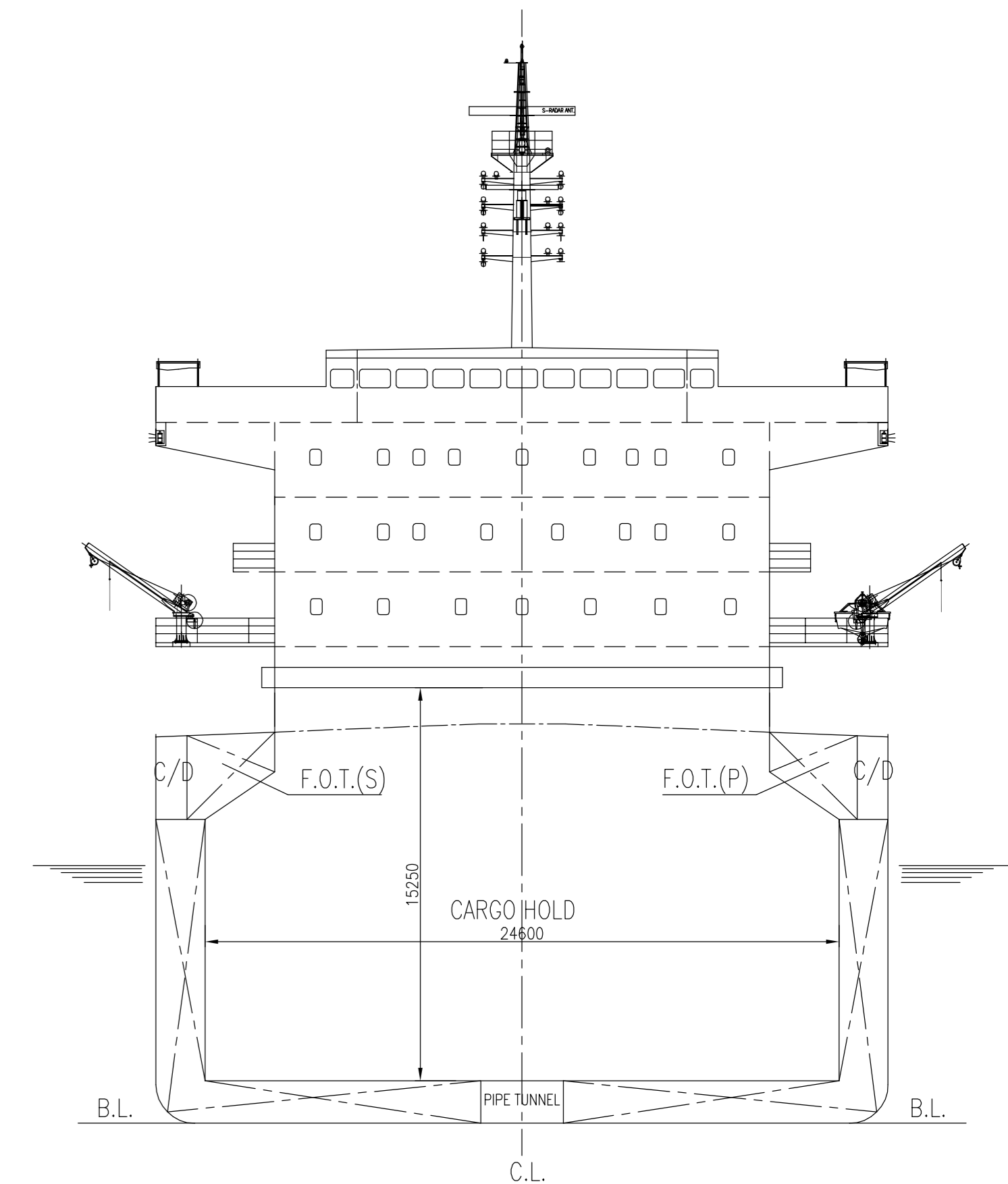

SHIP NAME: ASIA SPIRIT  
IMO No.: 9637430

BUILDER	NANJING DONGZE SHIPYARD CO.,LTD	HULL NO.	DZ06H-93
OWNER	ORIENTAL PIONEER SHIPPING LIMITED	CLASS	BV
TITLE	35,000 DWT BULK CARRIER	FINISHED PLAN	
DESIGNED	吴坤	DWG No.	JH429G2-100-05
CHECKED	唐伟杰	SCALE	No. WEIGHT PAGE DATE
VERIFIED	韩永辉	1:200	1/2
APPROVED	曹向东		

SHANGHAI BESTWAY MARINE ENGINEERING DESIGN CO.,LTD  
111 Cao Bao Road Shanghai, CHINA P.C:200223  
Tel:86-21-6436 5500 Fax:86-21-5448 7783 Email:luckway@mail.online.sh.cn

